

REV.	DESCRIPTION	DATE
A	PROPOSAL	Jan. 08, 2013
B	DELETE MYLAR	Jul. 05, 2013
C	MATERIAL MODIFY	Aug. 13, 2013

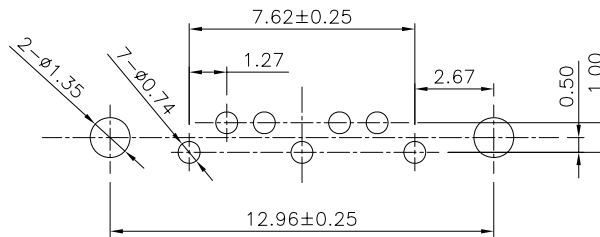

RECOMMEND PCB LAYOUT  
TOLERANCE:  $\pm 0.05$   
TOP VIEW

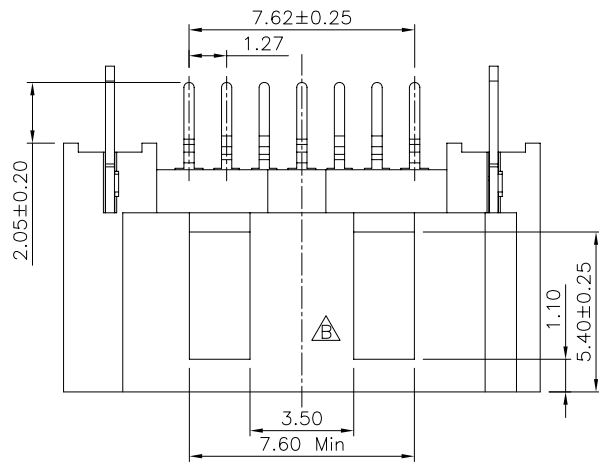
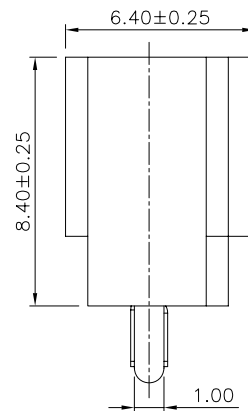
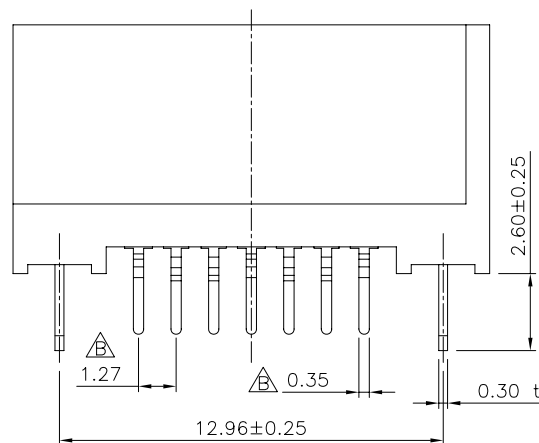
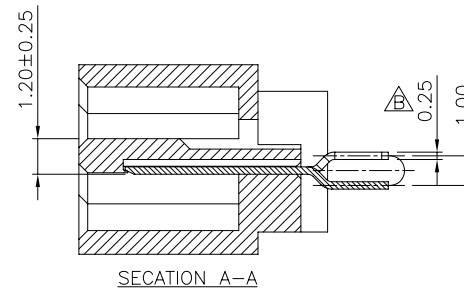
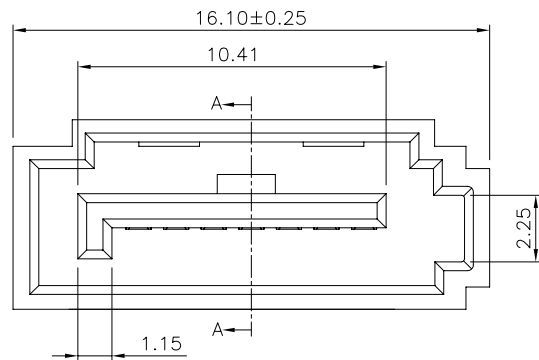

**MATERIAL:**

- HOUSING: L.C.P (UL 94V-0) BLACK.
- CONTACT: BRASS (t=0.25mm), GOLD PLATED ON CONTACT AREA, TIN PLATED ON SOLDER TAIL, UNDER NICKEL PLATED OVER ALL.
- FORK: BRASS (t=0.30mm), TIN PLATED.

**SPECIFICATION:**

- CONTACT RESISTANCE : 30mΩ MAX.
- INSULATION RESISTANCE : 1000MΩ MIN;
- DIELECTRIC STRENGTH: 500V/1MIN;
- OPERATING TEMPERATURE : -55°C TO +85°C.
- INSERTION FORCE: 45N MAX;
- EXTRACTION FORCE: 10N MIN.

**PART NUMBER INFORMATION :**

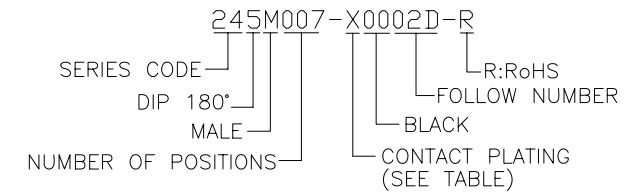

DESCRIPTION OF PLATING ON CONTACT			
NO.	EXPLAIN	NO.	EXPLAIN
0	GOLD FLASH	3	GOLD 15u"
6	GOLD 30u"		

TOLERANCE .0=±0.25 .00=±0.15 .000=±0.05 ANG.=±3°	DRAWER <i>JMG</i>	 <b>Astron</b> ASTRON TECHNOLOGY CORP.	
 UNITS : mm SCALE NONE SIZE A8	CHECK <i>JANPE</i>		NAME SATA 7P MALE 180° DIP WITH LATCH HIGH=8.4
	APP'D <i>ERPE</i>		DRAW NO. R245M007-X0002D-R
SHEET 1 OF 1	REV. C		

REV.	DESCRIPTION	DATE
A	RELEASE	Feb. 07, 2013
B	MODIFY	Dec. 18, 2013

SATA 7P →

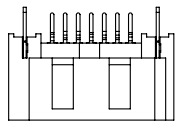

NOTE:

1.DIMENSION:(mm)

(1) TRAY: L=240、W=240、H=12

(2) OUT CARTON: L=520、W=260、H=215

2.QUANTITY:

(1) 130PCS/TRAY

(2) 15 TRAY/SHEAF(1950pcs)

(3) 4 SHEAF/CARTON(7800pcs)

130PCS/TRAY →

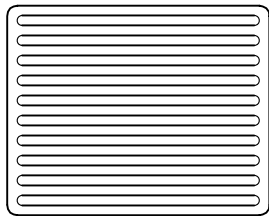

15 TRAY/SHEAF →

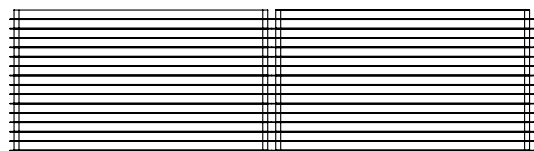
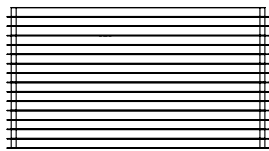

4 SHEAF/CARTON  
(7800pcs)

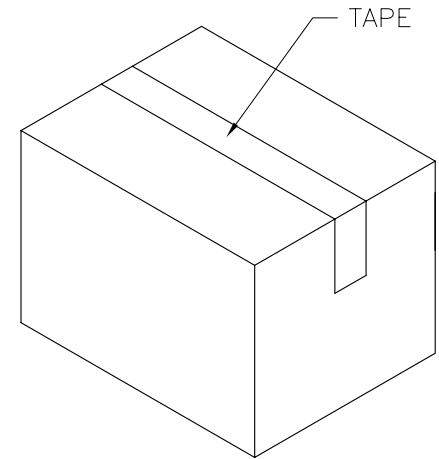
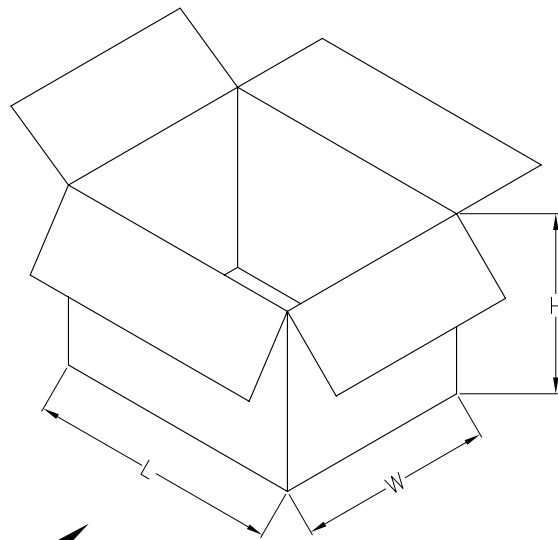

<p><u>TOLERANCE</u></p> <p>.0=±.XXX .00=±.XXX .000=±.XXX ANG.=±3°</p>		<p>DRAWER <i>JING</i></p>	<p><b>Astron</b> ASTRON TECHNOLOGY CORP.</p>	
<p>UNITS : mm</p>		<p>CHECK <i>JANICE</i></p>		<p>NAME HIGH RISE SERIAL ATA R/A DIP TYPE FEMALE (PACKAGE)</p>
<p>SCALE NONE</p>		<p>SIZE A5</p>	<p>PRODUCT SPEC. ---</p>	<p>DRAW NO. FOR: 245M007-X0002D-R</p>
<p>SHEET 1 OF 1</p>		<p>REV. B</p>		